

ONCE YOU CHOOSE
HOPE
ANYTHING IS POSSIBLE

Project By



VAISHNAVI
DEVELOPERS

Legal consultant
S C legals

Legal Rcc Engg.
Ana Consultant

Architects
DE-CON consultant

Site add

S no 36/6 shantabai charu mhatre nagar, Nr saket college
chinchpada village, kalyan (East)

Head office address
Vaishnavi Developers ,

Vaishnavi Plaza, near nageshwar mandir,
Chinchpada goan, katemanewali Road,
kalyan (east) 421306.

Contact No.: 9892560075 / 9321886582

CREDAI MCHI
RPM / MCHI / 517000 / KD / 153

Disclaimer: This brochure is purely conceptual and not a legal offering. The promoter / architects reserve the right to add / delete / alter any detail / specification / elevation maintain herein. The brochure is indicative of how the furniture can be arranged in the flat. No furniture of any nature is to be supply to the flat purchaser by the developer.

Arc Design 9769067777

Vaishnavi
PRIDE

MAHA RERA NO.: P51700046405

IT'S THE TIME TO
FLY HIGH

Project By



VAISHNAVI
DEVELOPERS



Location Map



MAKE YOUR
DREAMS
HAPPEN

Amenities

Accupressure pathway in garden

Ev-charging point in parking

Jogging track in garden

branded elevators

Temple instit

Gymnasium & yoga Room

Toddlers play area

Children play area

Ample parking space

Firefighting system

Senior citizen corner area

Designing lobby and passage

General amenities

All flats designs as per vastu shastra

Designer double height entrance lobby

Earthquake resistant RCC design

Construction with attractive elevation

Rain water harvesting for entire project

Branded lift with one stretch lift

Fire fitting facility as per govt. Norms

Power backup for lift

Flat Features

Branded modular electrical Fitting and switches

Provision for inverter points in flat

Walls painted with good quality paints

Provision for a/c point in and master bedroom

French window in living and bed with granite

Concealed plumbing and wiring

Provision for tv point in living room

Good quality flooring in entire flat

Kitchen Features

Good quality wall tiles kitchen

Granite kitchen platform with s.s.sink

Granite service platform with door level tiles

Provision for water purifier point in kitchen

Bathroom features

Good faucet fitting in all bathroom

Good quality wall tiles in bathroom

Provision for geyser point in bathroom

Elegant design bathroom door

Premium quality tiles

Premium sanitary ware

Safety features

Fire flighting system

CCTV surveillance for security







**ABOUT
KALYAN**

One of the highest rated locations in Mumbai conurbation on various Real Estate websites, Kalyan is the personification of beauty in its truest sense! A very important town in the Thane District that has gained significant exposure primarily as a residential sector, Kalyan is gearing towards becoming an economic hub. Even as a thriving town at the threshold of bursting into a prominent center, Kalyan is still nestled in the nature's pristine valley; providing an environment rich in natural beauty, that are eye-pleasing and soul-enriching!



3D Views



1BHK



2BHK



IT' TIME
TO BE
HAPPY



FAMILY
MAKES A HOUSE A
HOME

KDMC GARDEN



ROOF TOP AMENITIES

- GYMNASIUM
- MINI CLUB HOUSE
- PARTY HALL
- KIDS PLAY AREA
- WALKWAY
- GAZEBO



**BIG JOURNEY
BEGIN WITH
SMALL STEPS**



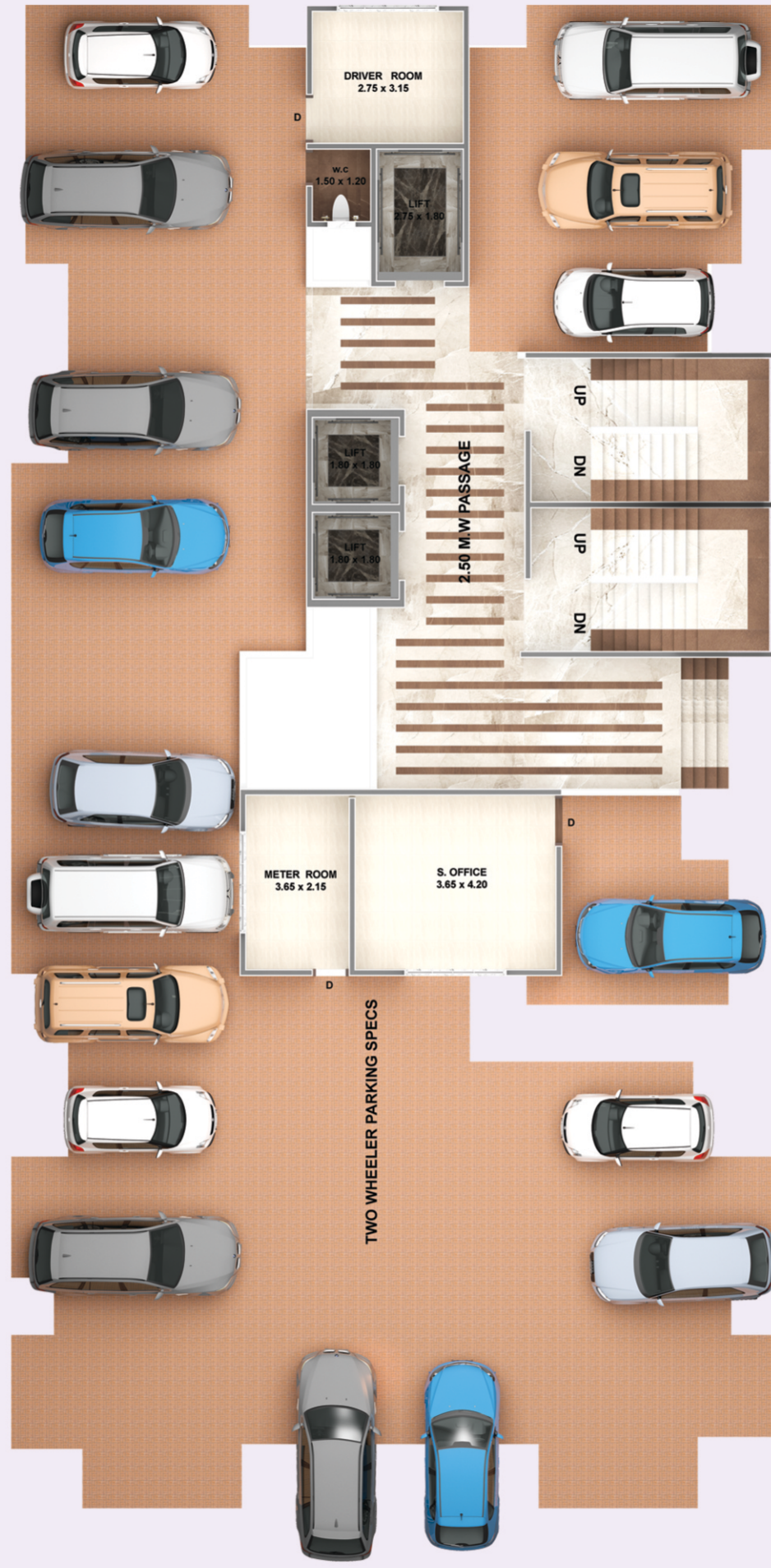

Stilt / Ground floor plan

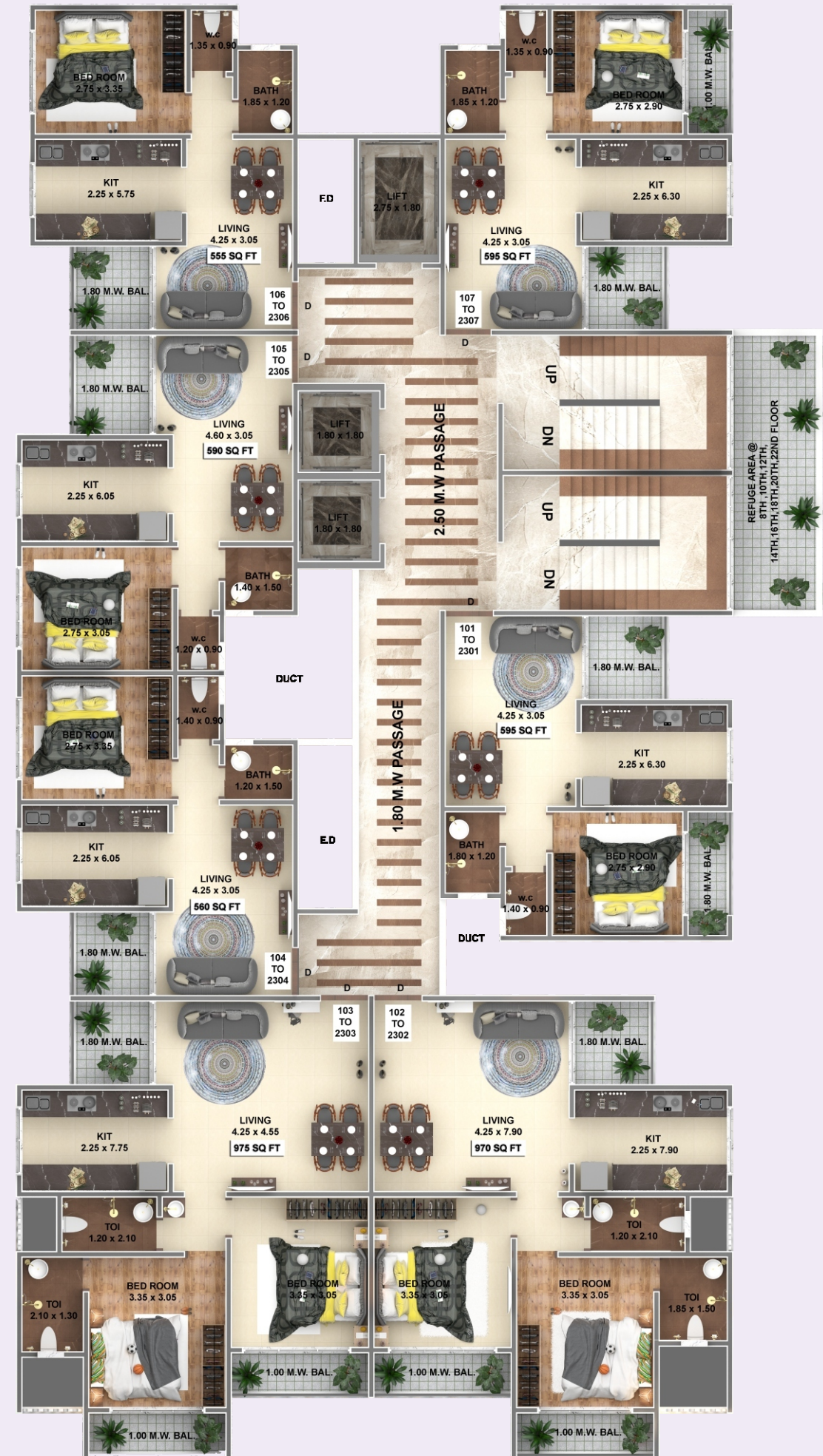

1st to 23th floor plan (11th to 23th Future expansion)