



# PRAGATI REVANTA

*Life full of Simplicity*



PRAGATI  
GROUP



**PRAGATI REVANTA**

Lush greens, Astonishing views, Lavish homes. Introducing **Pragati Revanta**. Strategically located in Ghatkopar (E), this premium G + 19 Floor Residential tower offers luxury 1 & 2BHK homes. With the view of providing luxurious living amidst the lush greens, every feature of the project, be it the location, the design, the materials, the open spaces are crafted to maximize the residents lifestyle.

Offering about a 112 luxurious 1BHK & 2BHK homes ranging from 396 to 719 sq.ft Rera Carpet Area, **Pragati Revanta** is here to fulfill your desire for a dream home.

## PROJECT HIGHLIGHTS:

MAHARERA Approved Project

G/Stilt + 19 Storey Iconic Tower (Proposed)

Luxurious 1 & 2 Bhk Apartments

Quality Construction with Hightech and Modern Amenities

Automated Car Parking Tower

Loan available through leading Banks and Financial institutions





# AMENITIES & SPECIFICATIONS

## STRUCTURE :

- Earthquake resistant Building.
- G+19 Storeyed RCC framed structure with concrete block masonry walls adding extra strength and stability.

## FLOORING:

- Superior quality Vitrified tiles (32"x32") for flooring and skirting in all rooms.

## KITCHEN:

- Granite kitchen platform.
- Branded SS Sink.
- Designer wall tiles.
- Exhaust fan

## TOILETS:

- Anti-skid tiles for flooring
- Superior quality Ceramic tiles for the walls.
- Premium Branded Bath and Sanitary C.P. fittings
- Branded Geyser and Exhaust Fan.

## DOORS AND WINDOWS:

- Designer laminated flush door with elegant handle and branded lock for doors.
- Wooden door frames for main door and all bedroom doors.
- Granite door frame for toilets.
- ACP doors for toilets.
- Powder coated/Anodized Aluminium sliding windows with clear glass.

- Combination of Black Granite and White Marble window frame.
- One panel mosquito prevention net.
- MS Grill for safety on windows.

## WALLS & PAINT:

- Gypsum finished internal walls.
- Premium quality paint for internal walls and ceiling.
- Premium quality Apex weather proof external emulsion paint for external walls.

## ELECTRIC:

- High grade concealed copper wiring with MCB.
- Adequate Electric, AC, TV, Telephone points.
- Internet Cat-6 Cable provided.
- Modern designer switches.

## LIFT:

- Total 2 Hightech lifts of reputed company (OTIS/KONE/SCHINDLER).

## FIRE SAFETY:

- Sprinkler system at common areas and in apartments.
- Portable fire Extinguisher.

# Typical Floor Plan (1st To 7th , 9th To 14th, 16th To 19th)

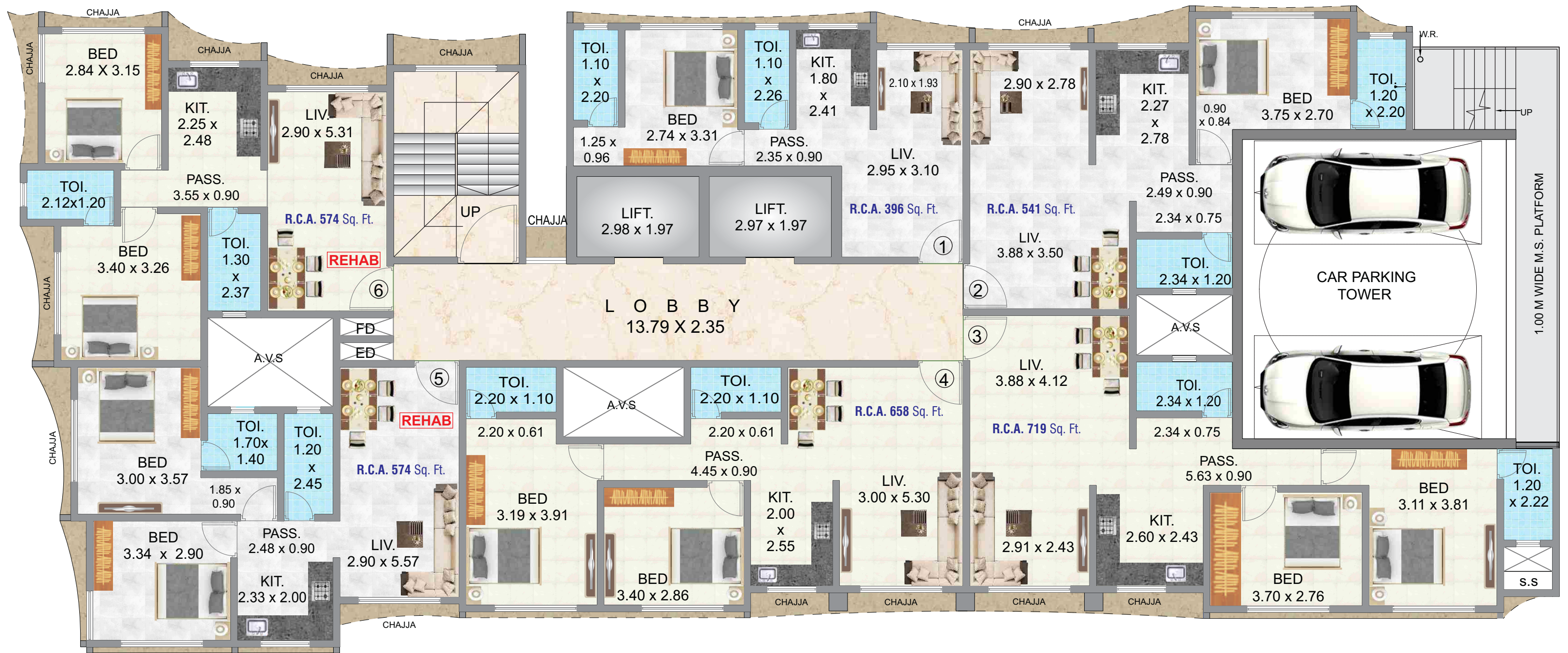

FLAT NO.	TYPE	RERA CARPET
1	1 BHK	396 Sq. Ft.
2	1 BHK	541 Sq. Ft.
3	2 BHK	719 Sq. Ft.
4	2 BHK	658 Sq. Ft.
4A	1 RK	355 Sq. Ft.
5	2 BHK	574 Sq. Ft.
6	2 BHK	574 Sq. Ft.

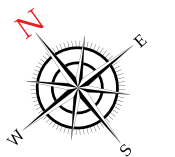

Note: The information is indicative of the kind of development that is proposed. It is prepared and issued in good faith and is for guidance only. It does not constitute part of any offer or contract. It is subject to the approval from the respective authorities. The photographs and the artist impressions in the brochure are for reference only. All the amenities provided subject to approval of MCGM.

# TOWER FEATURES

- Solid 5 ft. designed compound wall.
- Well designed main gate with security cabin.
- Grand air conditioned main entrance lobby.
- Tremix finish flooring for compound area.
- Society office on ground floor.
- Anti-termite treatment for Building foundation.
- Premium branded highspeed automated lifts.
- Hi-tech Gymnasium
- Common toilet on ground floor.
- Automated car parking tower.
- Underground and overhead water tanks with adequate storage capacity.
- 24/7 CCTV Camera surveillance.
- Power backup generator on ground floor for common areas.
- Fire-fighting system
- Rain water harvesting system.



1 BHK  
3D VIEW

2 BHK  
3D VIEW

Note: The information is indicative of the kind of development that is proposed. It is prepared and issued in good faith and is for guidance only. It does not constitute part of any offer or contract. It is subject to the approval from the respective authorities. The photographs and the artist impressions in the brochure are for reference only. All the amenities provided subject to approval of MCGM.

# CONNECTIVITY

## PUBLIC TRANSPORT

- Ghatkopar Metro Station 1 (8 mins. walk)
- Ghatkopar Railway Station (8 mins. walk)
- Ghatkopar Main Bus Depot (7 mins. walk)
- Lokmanya Tilak Terminus (5.4 kms)
- (Prop.) Pant Nagar Metro Station 4 (180 mtr.)

## HIGHWAY

- Santacruz - Chembur Link Road (3.5 kms.)
- Eastern Express Highway (1.3 kms.)
- LBS Road (1.3 kms.)
- Sion - Panvel Highway (6 kms.)

## AIRPORT

- Terminal 2 (7.5 kms.)
- Terminal 1 (10.5 kms.)

## HOSPITALS

- Parakh Hospital (11 mins. walk)
- Aashirwad Hospital (1.9 kms.)
- Rajawadi Hospital (2.4 kms.)

## SCHOOL / COLLEGE

- Somaiya School & College (2.8 kms.)
- Garodia International School (2.1 kms.)
- Shivaji Shikshan Sanstha School (1min. walk)
- Universal School (1.9 kms.)
- RBK International School (4 kms.)

## GARDENS

- Aacharya Atre Maidan (1 mins. walk)
- Arun Vaidya Maidan (4 mins. walk)
- Lions Garden (1.7 kms.)
- 90 Feet Garden (1.6 kms.)

## TEMPLE

- Siddhivinayak Temple (5 mins walk)
- Kukreja Jain Derasar (1.5 kms.)
- Parasdham (1.5 kms.)
- Ambe Mata Temple (7 mins. walk)
- Swaminarayan Temple (1.5 kms.)

## MALL

- R Odeon Mall (1.1 km.)
- R City Mall (2.3 km.)
- Phoenix Mall (4.3kms.)

## MULTIPLEX

- PVR Cinemas (1.2 km.)
- Inox (9 mins. walk)



Note: The information is indicative of the kind of development that is proposed. It is prepared and issued in good faith and is for guidance only. It does not constitute part of any offer or contract. It is subject to the approval from the respective authorities. The photographs and the artist impressions in the brochure are for reference only. All the amenities provided subject to approval of MCGM.

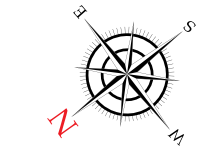
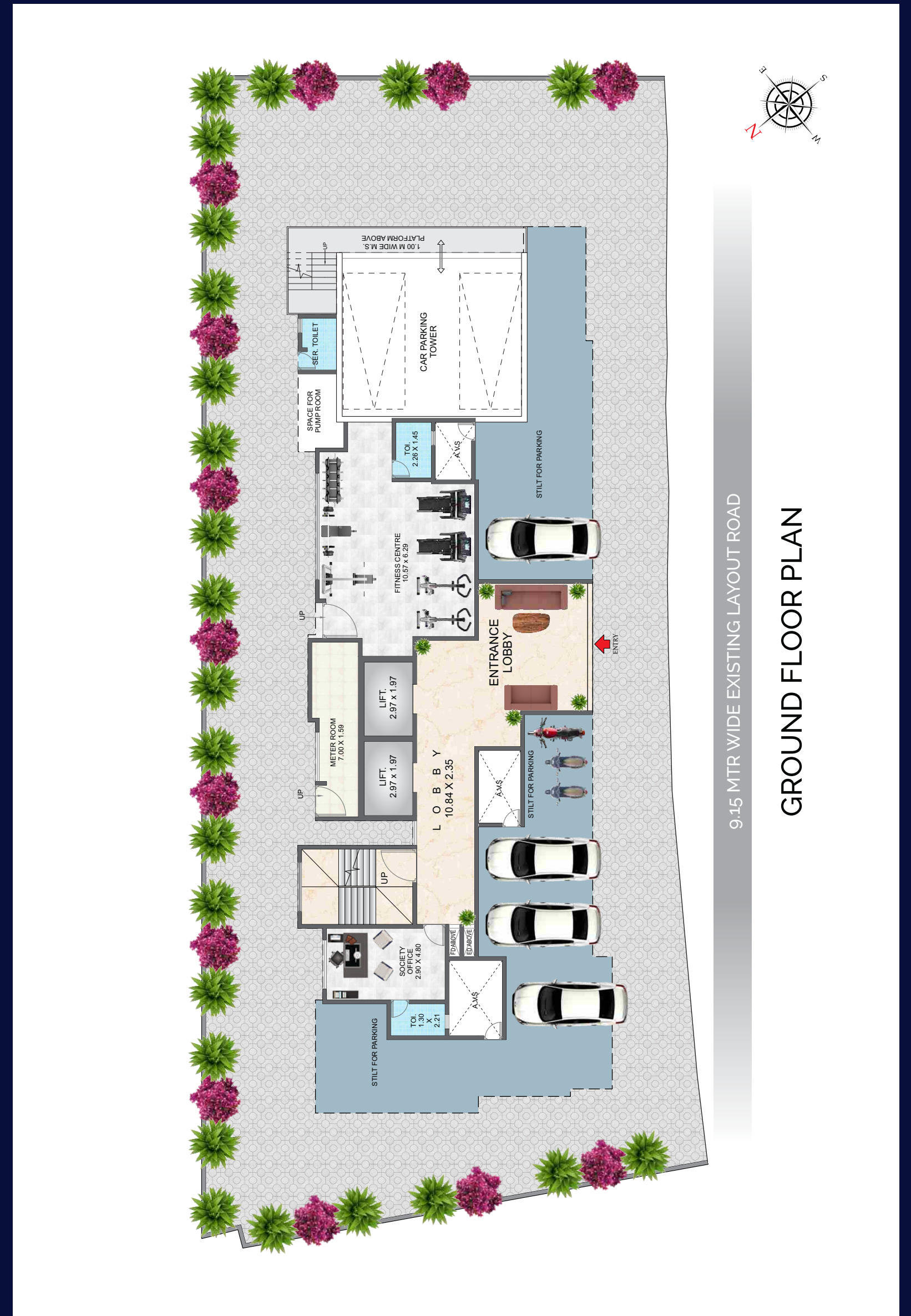

9-15 MTR WIDE EXISTING LAYOUT ROAD

## GROUND FLOOR PLAN



8TH FLOOR PLAN  
(REFUGE FLOOR)



15TH FLOOR PLAN  
(REFUGE FLOOR)

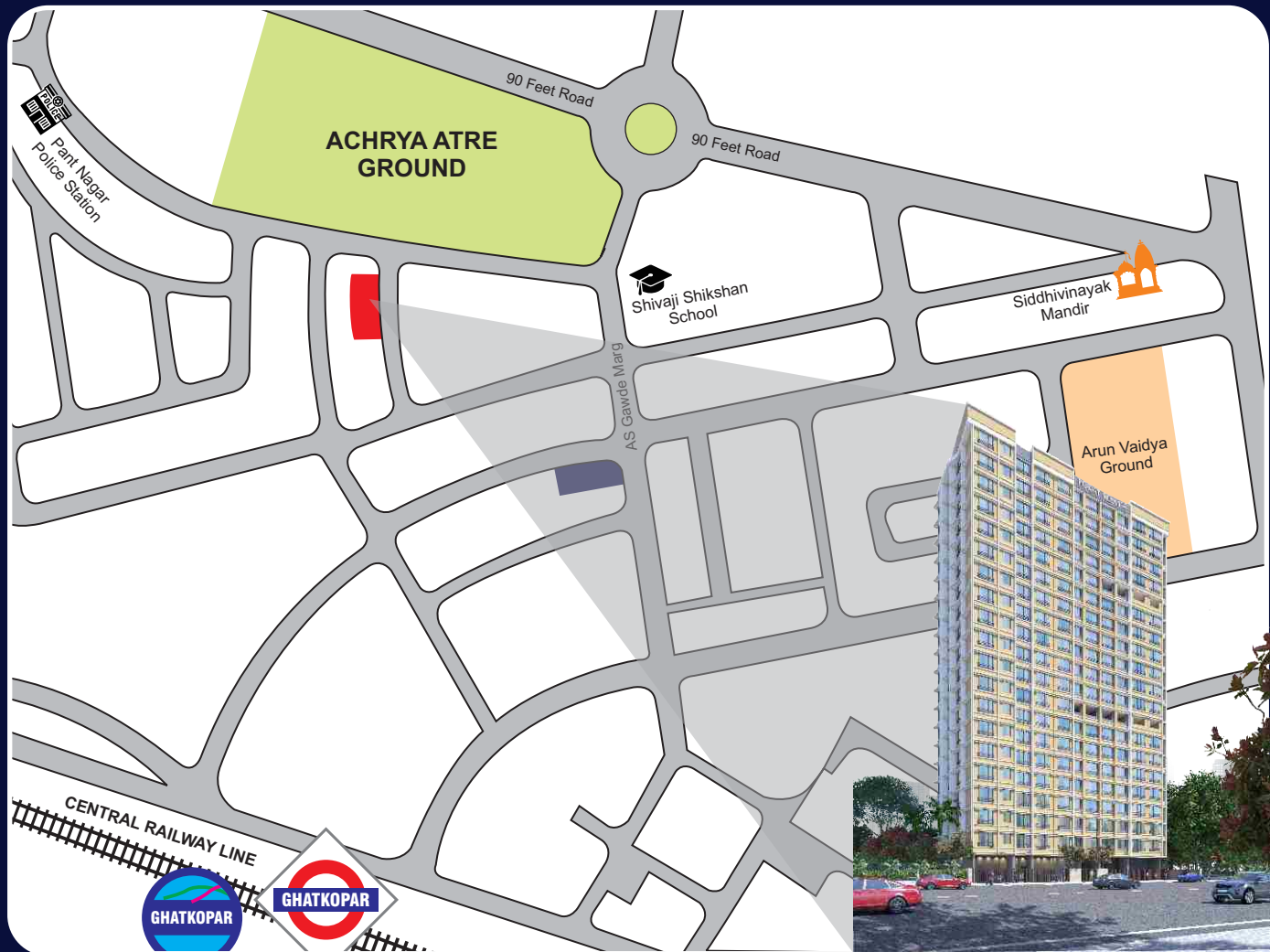

### COMPLETED PROJECTS



**SHIVALIC**  
SECTOR-5  
ULWE, NAVI MUMBAI



**PRAGATI PARK**  
SECTOR-5  
ULWE, NAVI MUMBAI



**SHIVALIC HEIGHT**  
SECTOR-20  
KALAMBOLI, NAVI MUMBAI



**OM SHIVSAGAR**  
BLDG. NO. 17  
TILAK NAGAR, MUMBAI



**PRAGATI ICON**  
BLDG. 33  
GHATKOPAR, MUMBAI

### ONGOING PROJECTS



**PRAGATI**  
GROUP

Office:  
101, J.K.Chamber, Sector-17,  
Vashi, Navi Mumbai. 400 703

Site Address:  
**PRAGATI REVANTA**  
Building No. 48, Sant Dyaneshwar Marg,  
Pant Nagar, Ghatkopar East, Mumbai - 400075

Sale Contact: **8433516141 / 8433518730**

Architect:  
**Space Design Architects, Vashi**

Legal Advisor:  
**S.C.Pal and Associates**

Rcc Consultant:  
**A.G. Gokhale & Associates**

MAHARERA Registration No.

Project Approved by **LEADING BANKS & NBFC's**

Note: The information in this brochure is indicative of the kind of development that is proposed. It is prepared and issued in good faith and is for guidance only. It does not constitute part of any offer or contract. It is subject to the approval from the respective authorities. In the interest of the continuing improvement of the project and or any changes as suggested by the authorities or the Developers reserve the right to alter the Layout, Plans, Specifications, Amenities or features of the buildings without any prior notice or obligation to any buyer's in the project. The photographs and the artists impressions in the brochure are for reference only. All the amenities provided subject to approval of MHADA • MCGM.